

1 Connecting LCCU-21 to PC by USB cable

Device Installation

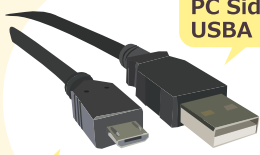

USB Cable



LCCU-21 Side
USB Micro B Male

PC Side
USBA Male

- 1 Connect the LCCU-21 and PC with the supplied USB cable
- 2 A software installation message will appear shortly as shown below

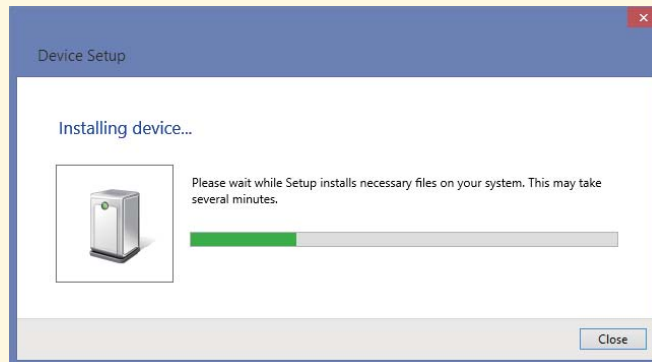

What to do if the COM Port is not known

- 1 Open the control panel window and click device manager
- 2 Expand the COM LPT Port option to reveal USB Serial Port (COM). The number after COM is the port number

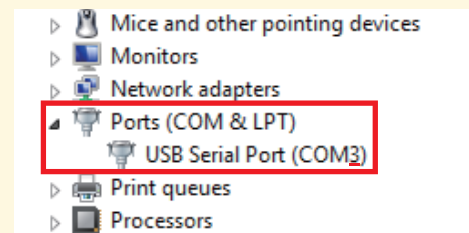

What to do if drivers were not installed automatically

- 1 Access the following link <http://www.ftdichip.com/FTDrivers.htm>
- 2 Press [click here](#)

▶ **Drivers**

PLEASE NOTE - When updating drivers, refer to the following document: [AN_107 - Advanced Driver Options](#)

New drivers are now available to support the [FT4222H](#) - for D2XX drivers please [click here](#).

- 3 Select setup executable and download

Windows*	2017-03-10	2.12.26	2.12.26	-	-	-	WHQL Certified. Includes VCP and D2XX. <div style="border: 1px solid red; padding: 2px; display: inline-block;">Available as a setup executable</div> Please read the Release Notes and Installation Guides.
----------	------------	---------	---------	---	---	---	--

- 4 After downloading [CDM v2.12.26 WHQL Certified.exe](#) click the file and install

Note: When CDM v2.12.26 WHQL Certified.exe is updated the version number, 2.12.26, will change